

Pitch:2.00mm

Board Spacer	Single Row/	Dual Row
Straight DIP Type		

Series 322 / 325

# sgdconn

[Http://www.sgdconn.com](http://www.sgdconn.com)

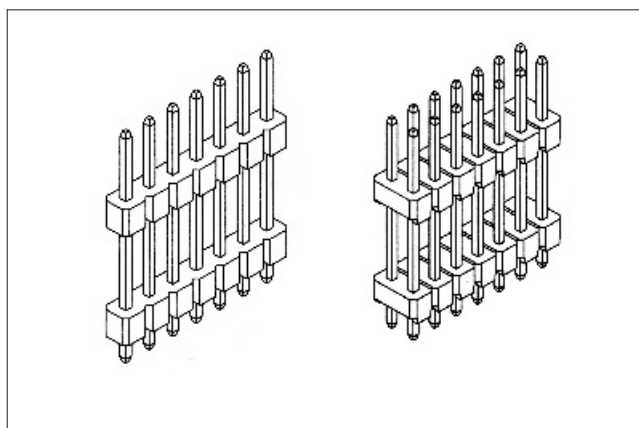

SPECIFICATIONS:

Current Rating: 2.0 AMP

Contact Resistance: 30m• Max

Insulation Resistance: 1000M• Min

Withstand Voltage: 500VAC/minute

Operation Temperature: -40°C to +105°C

**MATERIALS:**

Contact Material: Copper Alloy

Contact Plating: Gold or Tin over 50  $\mu$  " Ni

Insulator Material: Polyester(UL94V-0)

Standard: PA6T

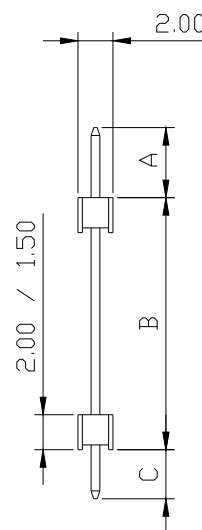
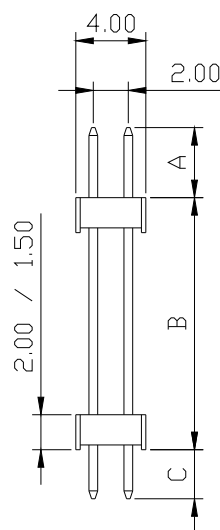
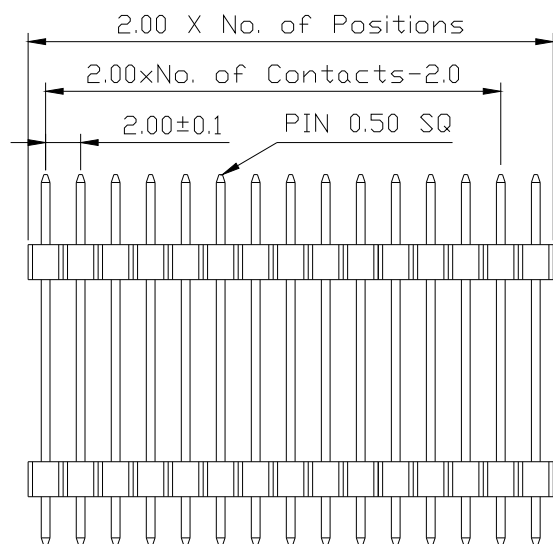
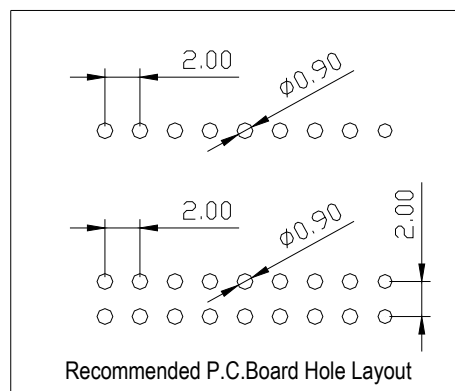
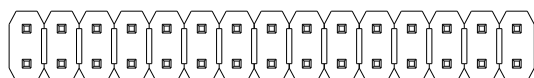

## Ordering Code

① ② ③ ④ ⑤ ⑥ ⑦ ⑧ ⑨ ⑩  
3 2 X X XX S 1 4 2 XXX

① Series No.:  
3= Pin Header

② Pitch:  $p = 2.00\text{mm}$

③ Insulator Height:  
2 = 2.00mm  
5 = 1.50mm

④ Dip Spacing:  
1=Single row  
2=Double row

⑤ Number of Contacts:  
Single row = 01 to 40  
Double row = 02 to 80

⑥ Tail & Mounting Style:  
S= Straight DIP type

⑦ Contact Plated  
0= Tin                      1= Gold Flash  
2= Gold 3u"              3= Gold 5u"  
4= Gold 10u"            5= Gold 15u"  
6= Gold 30u"

⑧ Material Type  
0=PPS 3=Nylon-66  
1=PBT 4=Nylon-6T  
2=LCP 5=PA46

⑨ Tiers of Body  
1 = Single tier  
2 = Double tier  
3 = Triple tier

⑩ Pin Length  
XXX=A+B+C

Due to technical progress, all the information provided is subject to change without prior notice.